



**Tartle**  
KITCHEN

**INSTRUCTION  
MANUAL**

# **HAMBURGER PATTY PRESS**

## **HP-04 / HP-05 / HP-06**

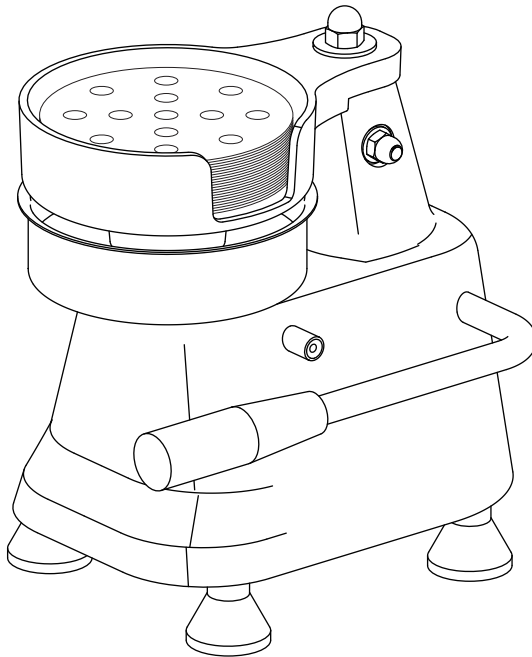

**Intertek**  
4007443

**Keep these instructions with the appliance.**

**Please make sure to read the enclosed Safety Instructions prior to using your unit.**



# 1. INSTALLATION

- Install the machine onto a solid, stable, non-slip surface. This area should be large enough to allow easy access& cleaning.
- Put the cellophane dises into the holder at the top of the machine.

## Meat Portion & Thickness Reference

Patty Size	4 inch	5 inch	6 inch
Capacity	100g-150g	150g-250g	220g-350g
Minimum	100g / 13mm	150g / 11mm	220g / 11.6mm
Maximum	150g / 17.6mm	250g / 15mm	350g / 21mm

# 2. USE

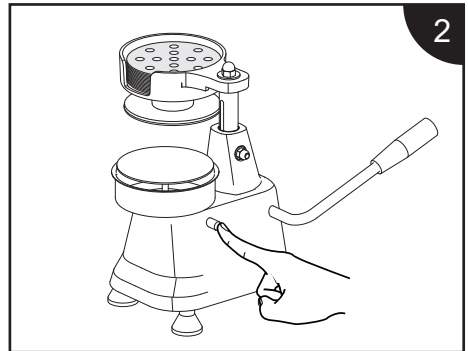
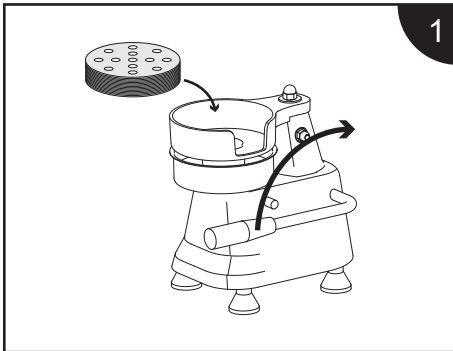

- Insert the stack of patty papers into the paper holder.
- Pull up the handle to expose the meat forming plate.

- Push the button to lower the forming plate.

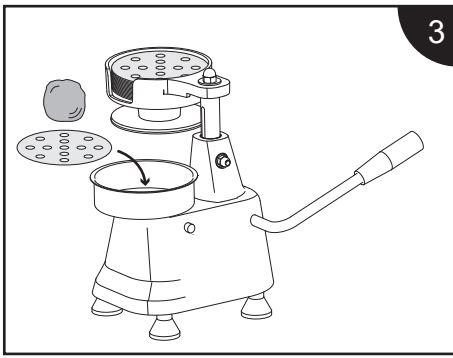

3

- Place a patty paper on the forming plate.
- Add a portion of minced meat—refer to our recommendation chart for portion size if needed.

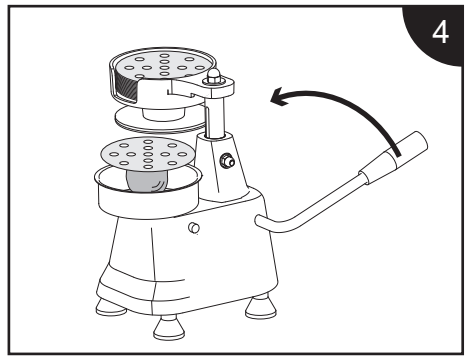

4

- Place another patty paper on top of the meat.
- Pull down the handle to form the hamburger patty.

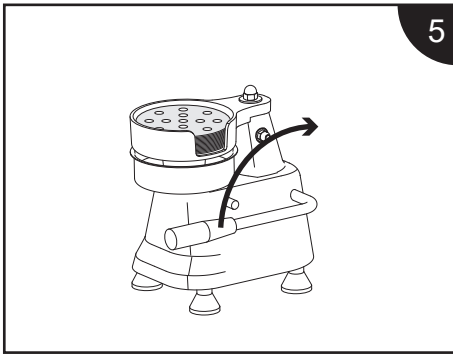

5

- Lift the handle to raise the patty for easy removal.

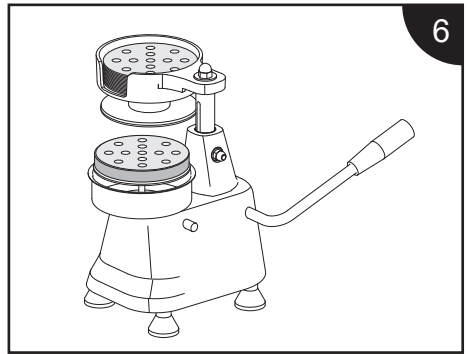

6

### 3. CLEANING

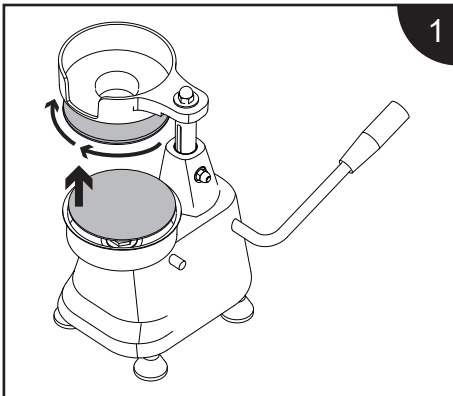

1

- Turn clockwise to detach the press plate.
- Remove the meat forming plate.

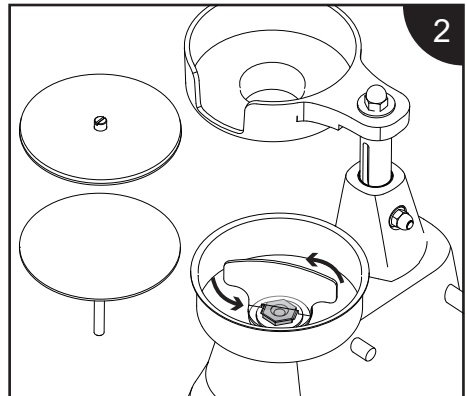

2

- Use the "T" Hand wrench to remove the nuts and detach the tray.

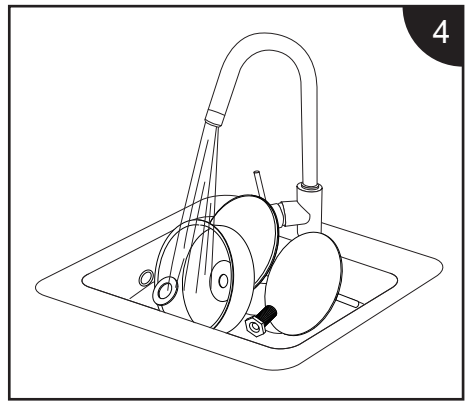
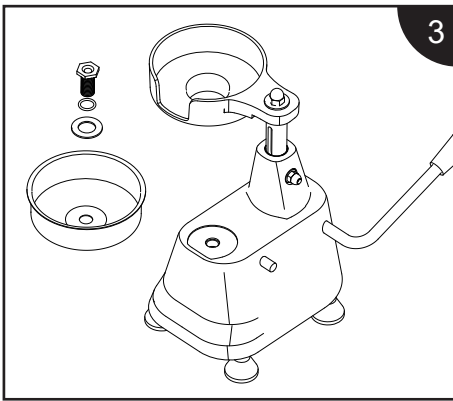

- Wipe the machine with a damp cloth, then dry thoroughly with a clean cloth
- If you hear water sloshing inside the machine by mistake, you can unscrew the four rubber feet by hand to remove the bottom plate (no tools required). Clean out any water or oil that may have accumulated inside.

## 4. PRODUCT DESCRIPTION

### Main technical parameters

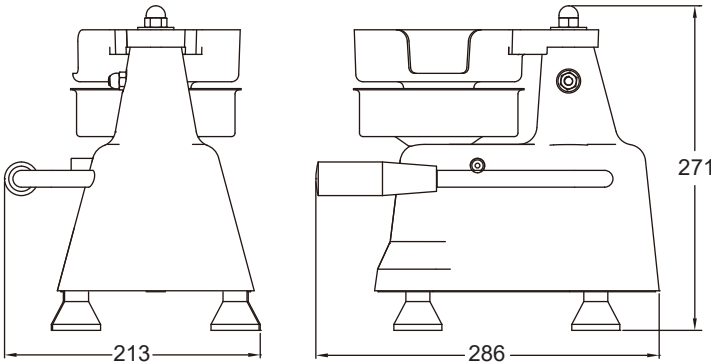

### Specs

Model	HP-04	HP-05	HP-06
PLATE SIZE	4 inch / 100mm	5 inch / 130mm	6 inch / 150mm
N.W./G.W.	4.35/5.30 kg	4.70/5.85 kg	4.95/6.10 kg
Box Size	31.3x26.5x30cm		

## 5. EXPLODED VIEW AND SPARE PARTS LISTS

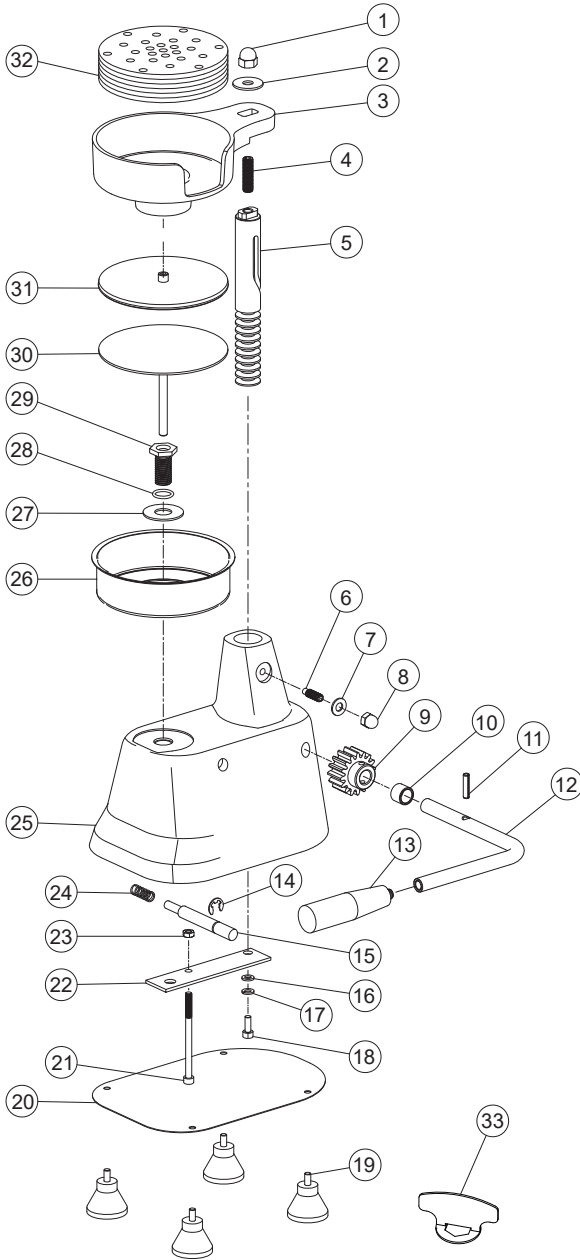

NO.	DESCRIPTION
1	Screw nut
2	Washer
3	Wax paper holder
4	Grub screw
5	Spindle
6	Guide screw
7	Washer
8	Screw nut
9	Gear
10	Gear ring
11	Elastic round pin
12	Pressing Rod
13	Handle
14	E-type circlip
15	Deflector rod
16	Washer
17	Clip
18	Hex socket screw
19	Rubber feet
20	Bottom plate
21	Hex socket screw
22	Support plate
23	M6 nut
24	Spring
25	Housing
26	Forming dish
27	Washer
28	Seal ring
29	Guide sleeve
30	Tray
31	Pressure plate
32	Oil absorbing paper
33	"T" Hand wrench